



# TIME TO EXPLORE

Cleveland Metroparks

## Vision for the Valley TLCI Planning Study

Board of Park  
Commissioners  
October 18, 2018

# TLCI Planning Study

- Transportation for Livable Communities Initiative (TLCI) Planning Study
- Awarded March 2018 (SFY 2018)
- Funding:
  - \$125,000 NOACA
  - \$50,000 City of Cleveland
  - \$50,000 Cleveland Metroparks
  - \$25,000 Port of Cleveland
- Timeline: January-December 2019



landscape art neighborhoods development



# Study Area



VISION FOR THE VALLEY  
OVERALL PROJECT STUDY EXTENTS



ZONE 1

ZONE 2

ZONE 3

I-280

I-480

HARVARD AVE

# Study Area Developments

FLATS EAST BANK DEVELOPMENT



FLATS WEST BANK DEVELOPMENT



CANAL BASIN PARK



VISION FOR THE VALLEY  
IN DEVELOPMENT RIVER PROJECTS



TRAILWAYS



IRISHTOWN BEND



RED LINE GREENWAY

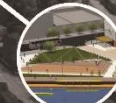

THE FOUNDRY



THUNDERBIRD DEVELOPMENT

# Study Elements

---

- Land use vision
- Connectivity plan
  - Multimodal options
  - Trail connectivity
  - Freight/Maritime
  - Rail
  - Traffic Analysis
- River safety
- Public spaces
- Branding and marketing of the Cuyahoga River Valley
- Unified vision



# TIME TO EXPLORE

Cleveland Metroparks

## Vision for the Valley TLCI Planning Study

Board of Park  
Commissioners  
October 18, 2018