

JUN 29 1938

PZ - 32 - 2414







Perkins Beach 1956



Perkins Beach 1968



Perkins Beach 1973



Perkins Beach 1980



Perkins Beach 1986



Perkins Beach 1989



Perkins Beach 1993



Perkins Beach 1997



Perkins Beach 2002



Perkins Beach 2003



Perkins Beach 2004



Perkins Beach 2006



LEGEND

- SB-1 SOIL BORING LOCATION
- A-1, B-1 SAND SAMPLING LOCATION
- P-1 ROCK PROBING LOCATION

CONTROL POINTS	NORTHING	EASTING
1	664634.9370	2173839.3340
2	664646.410	2173656.6320
3	664942.5530	2172432.0190

NOTES

1. VERTICAL DATUM IS IGLD 1985.
2. BATHYMETRIC SURVEY PERFORMED BY KS ASSOCIATES INC. ON 10-02-2014 AND 10-13-2014. TOPOGRAPHIC SURVEY PERFORMED BY KS ASSOCIATES INC. ON 12-08-2014.
3. ROCK PROBINGS PERFORMED BY SHORELINE CONTRACTORS AND KS ASSOCIATES INC. ON 10-27-2014.
4. SOIL BORINGS PERFORMED BY OHIO TEST BORE ON 11-11-2014, 11-12-2014, 12-08-2014 AND 12-09-2014.
5. ALL SAND AND GRAVEL IN THE FOOTPRINT OF THE REVETMENT REPAIR AREAS SHALL BE EXCAVATED AND SIDECAST DOWNDRIFT OF EACH GROIN.
6. TOE OF NEW STONE SLOPE SHALL BE ENTRENCHED A MINIMUM OF 2 FEET INTO SHALE BEDROCK.

FILL VOID IN REVETMENT FROM DEMOLITION OF GROINS WITH 12 LF OF NEW ODOT A STONE REVETMENT, AT 24:1V SLOPE, CREST ELEVATION 584 FT TOE ELEVATION 578 FT

BASE BID 1 & 2
SITE PLAN, PERKINS BEACH



KS KS Associates, Inc.
 260 Burns Road, Suite 100
 Elyria, OH 44035
 P 440 365 4730
 F 440 365 4790
 www.ksassociates.com

KS ASSOCIATES
 KS PROJECT NO. 14233-1

4-20-2017
 SUBMITTAL
 STATE OF OHIO
 MARK P. GENDER
 REGISTERED PROFESSIONAL ENGINEER

Cleveland Metroparks
 PROJECT NUMBER : 14233-1
 www.clevelandmetroparks.com

BASE BID 1 & 2, SITE PLAN
 PERKINS BEACH
 EDGEWATER PARK
 CLEVELAND METROPARKS
 4101 FULTON PARKWAY
 CLEVELAND, OHIO 44144

REVISIONS	DATE	BY

SCALE CHECK: THIS MARK SHOULD MEASURE EXACTLY 1" WHEN PLOTTED

REVISIONS	DATE	BY

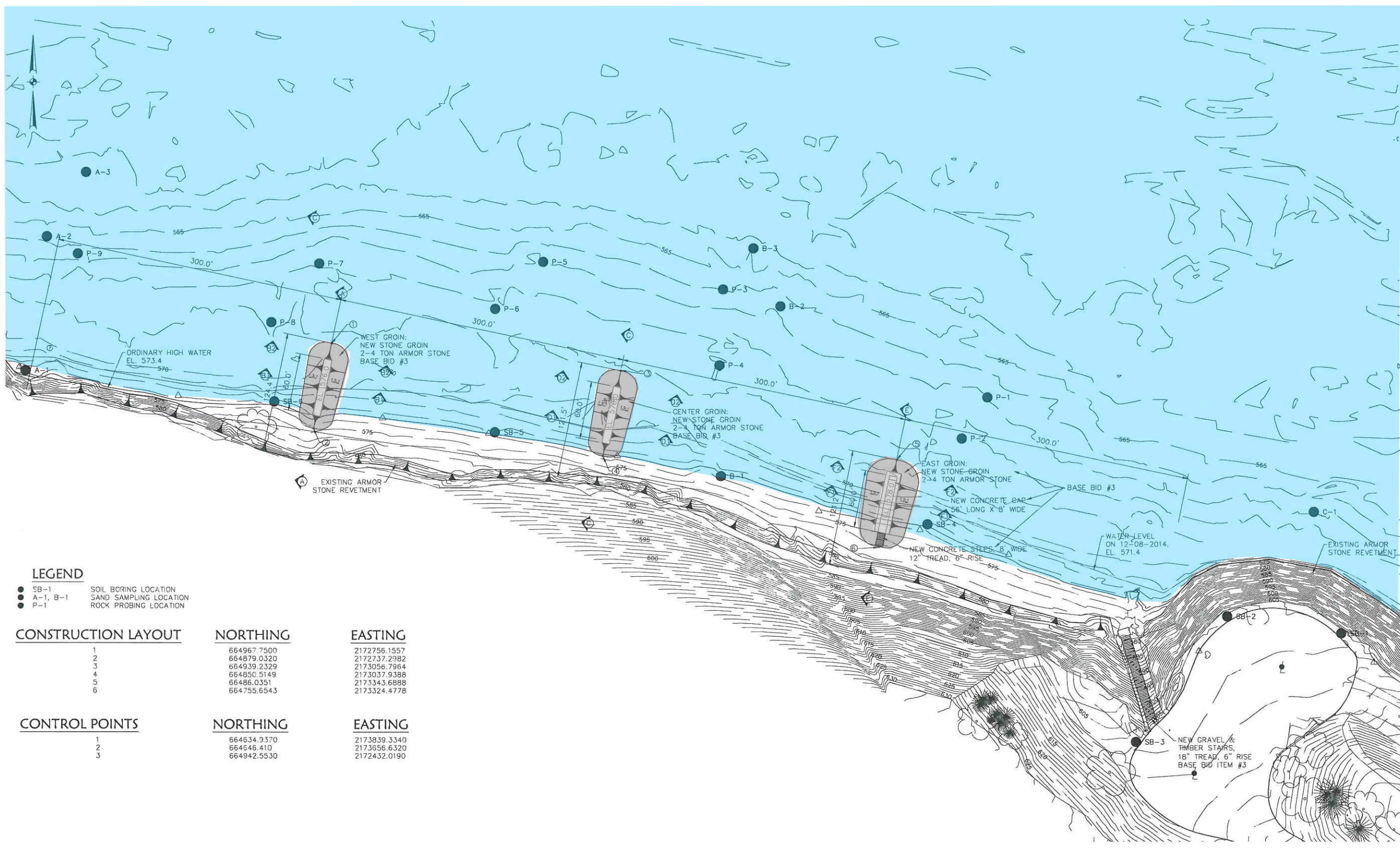

LEGEND

- SB-1 SOIL BORING LOCATION
- A-1, B-1 SAND SAMPLING LOCATION
- P-1 ROCK PROBING LOCATION

CONSTRUCTION LAYOUT

- 1
- 2
- 3
- 4
- 5
- 6

NORTHING

- 664967.7500
- 664879.0320
- 664939.2329
- 664850.5149
- 66486.0351
- 664755.6543

EASTING

- 2172756.1557
- 2172737.2982
- 2173056.7964
- 2173037.9388
- 2173343.6888
- 2173324.4778

CONTROL POINTS

- 1
- 2
- 3

NORTHING

- 664634.9370
- 664646.410
- 664942.5530

EASTING

- 2173839.3340
- 2173656.6320
- 2172432.0190

NOTES

1. VERTICAL DATUM IS IGLD 1985.
2. BATHYMETRIC SURVEY PERFORMED BY KS ASSOCIATES INC. ON 10-02-2014 AND 10-13-2014. TOPOGRAPHIC SURVEY PERFORMED BY KS ASSOCIATES INC. ON 12-08-2014.
3. ROCK PROBINGS PERFORMED BY SHORELINE CONTRACTORS AND KS ASSOCIATES INC. ON 10-27-2014.
4. SOIL BORINGS PERFORMED BY OHIO TEST BORE ON 11-11-2014, 11-12-2014, 12-08-2014 AND 12-09-2014.
5. ALL SAND AND GRAVEL IN THE FOOTPRINT OF THE NEW GROINS SHALL BE EXCAVATED AND SIDECAST DOWNDRIFT OF EACH GROIN.
6. TOE STONE (3 TO 5-TON ARMOR STONE) SHALL BE ENTRENCHED A MINIMUM OF 2 FEET INTO SHALE BEDROCK.
7. ALL CONCRETE RUBBLE SHALL BE FREE OF EXPOSED REBAR.
8. CAST-IN-PLACE CONCRETE SHALL HAVE A MINIMUM 28-DAY COMPRESSIVE STRENGTH OF 4,000 PSI. AS REQUIRED BY SPECIFICATION SECTION 03 30 00.
9. REINFORCEMENT STEEL SHALL HAVE A MINIMUM YIELD STRENGTH OF 60,000 PSI. AS REQUIRED BY SPECIFICATION SECTION 03 20 00.
10. CONCRETE CAP ON EAST GROIN SHALL HAVE A 1-INCH PREFORMED EXPANSION JOINT AT MIDPOINT (28 FEET FROM EACH END OF 56-FOOT LONG CAP) AND CONTRACTION JOINTS AT 14 FEET ON CENTER)

BASE BID 3
SITE PLAN, PERKINS BEACH



KS Associates, Inc.
 260 Burns Road, Suite 100
 Elyria, OH 44035
 P 440 365 4730
 F 440 365 4790
 www.ksassociates.com
 KS PROJECT NO. 14233-1

R:\14000\14233-1\Drawings\2017-04-20 Final Bid Documents\14233-1-08 Site Plan Base Bid 3 042017.dwg/20/2017 3:00 PM